

# 8900 Extra Heavy-Duty Full-Extension Drawer Slide

*Ideal for use wherever extra strength and durability are required, such as industrial, commercial or vehicle large storage drawer applications.*

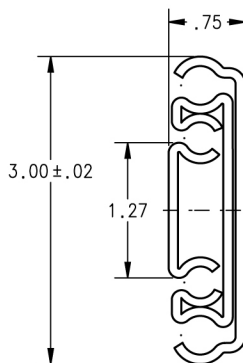

**number** 8900 — Extra Heavy-Duty Full-Extension Slide

**mounting** Side or Flat

**height** 3" (+.020, -.020)

**clearance** 3/4" (+.030, -.030)

**load rating** 180 to 500 lbs. (based on application)

**finish** Zinc plated with clear chromate

**action** Telescopic movement on precision steel ball bearings

**features**

- Heavy-duty ball-bearings carry the heaviest loads without sticking
- Heavy-duty stops are designed to survive rough field use
- Non-handed design for easy installation
- Non-metallic open and closed stops assure smooth, silent operation

**sizes** 12", 14", 16", 18", 20", 22", 24", 26", 28", 30", 32", 34", 36", 40", 42", 48", 60"

**hardware**

- #10 (82°) flathead machine screws on cabinet member
- #10 panhead machine screws on drawer channel (all hardware customer supplied)

**packed**

- Bulk Pack (8900B):
  - 12" to 20" - 4 pair per box
  - 22" to 28" - 3 pair per box
  - 30" to 36" - 2 pair per box
  - 40", 42", 48" and 60" - 1 pair per box
- Poly Pack (8900P):
  - 12" to 20" - 4 pair per box
  - 22" to 28" - 3 pair per box
  - 30" to 36" - 2 pair per box
- Mounting hardware not included.
- One set of installation instructions included.

*NOTE: The 8900 extra heavy-duty slide is designed for applications in the 180 to 500-pound class based on application: Modest Use: 500 lbs.; Normal Use: 400 lbs.; Vehicular Use: 300 lbs.; Flat Mount: 180 lbs. This slide must never be used as a pull-out step, platform or any other application supporting human weight as injury may result.*